

How to Assemble and Pack Away Your Airflow Adventure

IMPORTANT: The assembly and packing away of your Airflow Adventure should always be carried out by two responsible adults. If you have any questions, please telephone our Customer Services Department on +44 151 495 1677 who will be delighted to help.

Your Airflow Adventure system will come ready assembled and will simply require careful positioning, pegging down and attachment to the fan unit before use. Please read the instructions and safety notice below, before starting to position the item for play.

Before You Start

1. This leaflet gives instructions for assembling your Airflow Adventure. Please read them carefully.
2. We recommend that you check all parts against the Parts List before starting. Do this by laying out the parts on a flat surface.
3. Two adults should assemble the Airflow Adventure system.
4. Assembly should take approximately 15 minutes. Taking time over assembly helps to ensure safety.

Assembly

1. Once you have checked that all parts are present, position your Airflow Adventure on a level surface, ideally grass or sand – NEVER on a hard surface.
2. Please ensure that you have adequate space for assembly and allow at least 2 m (80") around each face of the system. For comfort and safety, you should clear away any stones etc. from the play zone.
3. Each pod includes openings as entry and/or exit points. You may use any of these openings as an entry or exit point depending upon the configuration decided for the assembly. Tunnels should be used as escape hatches only.
4. The assembly may be configured in a square, straight, 'L', 'Z' or 'T' shape.
5. The connection of tunnels, doors and seals are detailed in the following diagrams. When connecting tunnels please ensure red markers on tunnel and pod are aligned.

How two connect a tunnel:

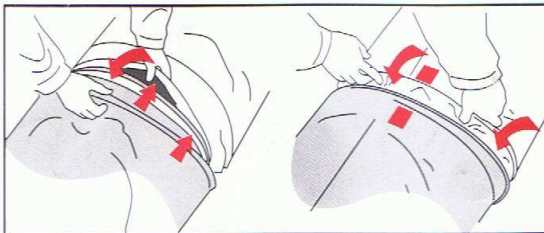

Connecting a door:

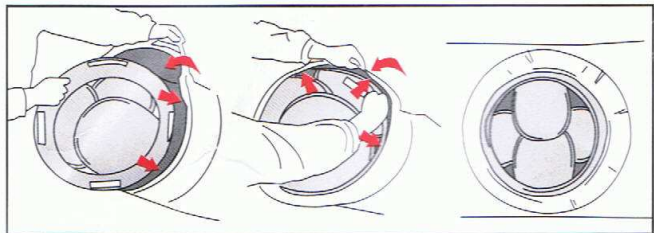

Connecting an escape hatch:

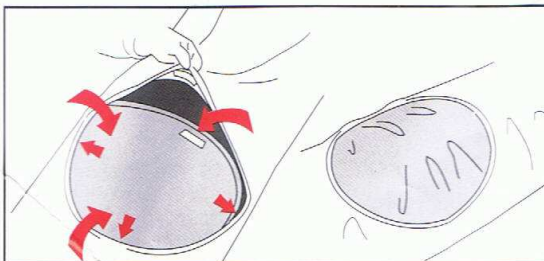

The Pirates Galley is connected to the Airflow Fan as detailed below:

